

FUNDY Engineering

19 July 2005

David Peacock
Meridian Construction and Development
209 Black River Road
Saint John, N.B.
E2L 3V9

**RE: Geotechnical Investigation – Ashburn Lake Road
Saint John, N.B.**

Dear Mr. Peacock:

Further to the your request, Fundy Engineering & Consulting Ltd. (Fundy Engineering) was retained to carry out a borehole program to identify the underlying soils and depth to bedrock in the Ashburn Lake Road area. The borehole program was carried out under the supervision of Gordon Moulard, M.Eng., Alex Moulard, EIT and Andrew MacVey EIT of Fundy Engineering on June 21, 2005. The boreholes were performed by Lantech using a track mounted drill.

The investigation was carried out after a review of the plan as supplied by Meridian Construction and Development, and a request for information regarding buried services in the areas to be excavated.

Eight boreholes were put down, to determine the nature of the underlying soils and depth to bedrock. Borehole logs, and location plan are appended to this letter report. In general the soil underlying the above mentioned site can be characterized as Very Soft Clayey Silt over Organic Black Peat over Bedrock. The depth to bedrock at this site ranged from 11 feet to 129 feet.

Serving Our Clients Needs First

27 Wellington Row
P.O. Box 6626
Saint John, NB
Canada E2L 4S1

Tel: (506) 635-1506
Fax: (506) 635-0206
fundy@fundyeng.com
www.fundyeng.com

I trust the above is sufficient for your present purposes. Should you have any questions or require additional information please contact Alex Mouland, or the undersigned at your convenience.

Yours truly,
FUNDY ENGINEERING & CONSULTING LTD.

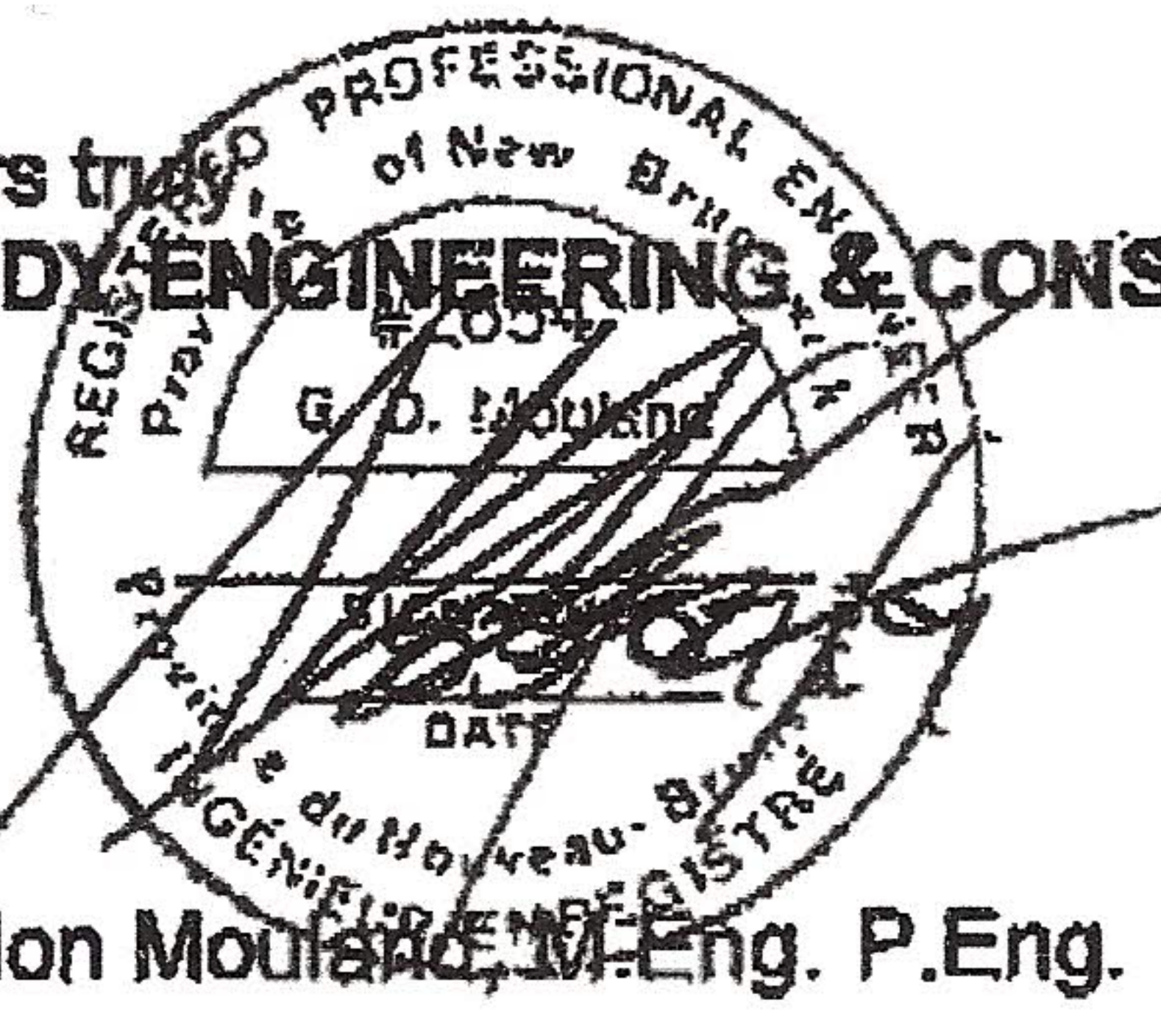

Gordon Mouland, M.Eng. P.Eng.

Alex Mouland, EIT

Project No: 4215

Borehole Number: 1

Project: Bedrock Depth

Client: Meridian Construction & Development Drill Date: June 21, 2005

Site Location: Asburn Lake Road

Engineer: Gordon Moulard

**FUNDY
ENGINEERING**

SUBSURFACE PROFILE			SAMPLE					SPT/Moisture Content												
Depth (ft)	Elevation	Description	Symbol	Number	Type	N value/RQD	Recovery	Water Level	N-Value/%											
									10	20	30	40	50	60	70	80	90			
									Shear Vane Test											
									MPa											
									1	2	3	4								
0	0.00	Ground Surface																		
1		Very Soft Dark Greyish Brown Clayey Silty																		
2																				
3																				
4																				
5	-5.00	Very Soft to Soft Grey Clayey Silt		1	SS	1	14"													
6																				
7																				
8																				
9		Black Peat Seams																		
10																				
11																				
12																				
13		Organic Material																		
14																				
15																				
16																				
17		Soft Black Organic Peat		3	SS	2	4"													
18																				
19																				
20																				
21		Soft Black Organic Peat		4	SS	1	8"													
22																				
23																				
24	-24.00																			
25		Soft Black Organic Peat		5	SS	2	10"													
26																				
27																				
28																				
29		Soft to Firm Brown Silty Sand and Gravel TILL																		
30																				
31	-31.00																			
32																				
33		Shale Bedrock																		
34																				
35	-35.00																			
36	-36.00																			
37		End of Borehole																		
38																				
39																				
40																				

Drilled By: Lantech Drilling Services

Datum: Assumed

Sheet: 1 of 1

Project No: 4215

Borehole Number: 2

Project: Bedrock Depth

Client: Meridian Construction & Development Drill Date: June 21, 2005

Site Location: Ashburn Lake Road

Engineer: Gordon Moulard

**FUNDY
ENGINEERING**

SUBSURFACE PROFILE			SAMPLE					SPT/Moisture Content					
Depth (ft)	Elevation	Description	Symbol	Number	Type	N value/RQD	Recovery	Water Level	N-Value/%				
									10	20	30	40	50
									Shear Vane Test				
									MPa				
									1	2	3	4	
	0.00	Ground Surface											
		Very Soft Dark Greyish Brown Clayey Silty (Augered to 10 feet)											
	-10.00	Very Soft Greyish Brown Clayey Silt With Organics		1	SS	0	14"						
				2	SS	0	24"						
				3	SS	0	24"						
	-25.00	Very Soft to Soft Reddish Brown Silt With Organics		4	SS	2	17"						
				5	SS	4	24"						
				6	SS	6	24"						
	-40.00	Black Silt With Organics		7	SS	6	20"						
	-42.00												
		Drove pencone to Bedrock Refusal @ 82.5 feet.											
	-82.50												

Drilled By: Lantech Drilling Services

Datum: Assumed

Sheet: 1 of 1

Project No: 4215

Borehole Number: 3

Project: Bedrock Depth

Client: Meridian Construction & Development Drill Date: June 21, 2005

Site Location: Ashburn Lake Road

Engineer: Gordon Moulard

**FUNDY
ENGINEERING**

SUBSURFACE PROFILE			SAMPLE					SPT/Moisture Content											
Depth (ft)	Elevation	Description	Symbol	Number	Type	N value/RQD	Recovery	Water Level	N-Value/%										
									10	20	30	40	50	60	70	80	90		
									Shear Vane Test										
									MPa										
									1	2	3	4							
	0.00	Ground Surface																	
		Very Soft Dark Brown Peat Over Soft Grey Clayey Silt (Augered to 10 feet)																	
	-10.00	Very Soft Greyish Clayey Silt With Organics		1	SS	0	0												
			2	SS	0	6"													
			3	SS	0	24"													
	-25.00	Very Soft to Soft Grey With Trace of Reddish Brown Silt With Organics		4	SS	0	24"												
			5	SS	0	24"													
			6	SS	6	24"													
	-40.00	Black Silt With Organics		7	SS	2	20"												
	-42.00																		
		Drove pencone to Bedrock Refusal @ 95 feet.																	
	-95.00	End of Borehole																	

Drilled By: Lantech Drilling Services

Datum: Assumed

Sheet: 1 of 1

Project No: 4215

Borehole Number: 4

Project: Bedrock Depth

Client: Meridian Construction & Development Drill Date: June 22, 2005

Site Location: Ashburn Lake Road

Engineer: Gordon Moulard

**FUNDY
ENGINEERING**

SUBSURFACE PROFILE			SAMPLE					SPT/Moisture Content						
Depth (ft)	Elevation	Description	Symbol	Number	Type	N value/RQD	Recovery	Water Level	N-Value/%					
									10	20	30	40	50	60
									Shear Vane Test					
									MPa					
									1	2	3	4		
	0.00	Ground Surface												
		Pushed Pencone to 76 feet in depth.												
	-76.00	Hammered Pencone to Bedrock Refusal at 129 feet.												
	-129.00	End of Borehole												

Drilled By: Lantech Drilling Services

Datum: Assumed

Sheet: 1 of 1

Project No: 4215

Borehole Number: 5

Project: Bedrock Depth

Client: Meridian Construction & Development Drill Date: June 23, 2005

Site Location: Ashburn Lake Road

Engineer: Gordon Mouland

**FUNDY
ENGINEERING**

SUBSURFACE PROFILE			SAMPLE					SPT/Moisture Content					
Depth (ft)	Elevation	Description	Symbol	Number	Type	N value/RQD	Recovery	Water Level	N-Value/%				
									10	20	30	40	50
									Shear Vane Test				
									MPa				
									1	2	3	4	
0.00		Ground Surface											
		Loose Grey Silt With Organics											
				1	SS	0							
				2	SS	0							
				3	SS	0							
				4	SS	0							
				5	SS	3							
				6	SS	1							
-42.00		Pushed Pencone to 70 feet.		7	SS	1							
-70.00		Hammered Pencone to Bedrock Refusal.											
-99.00		End of Borehole											

Drilled By: Lantech Drilling Services

Datum: Assumed

Sheet: 1 of 1

Project No: 4215

Borehole Number: 6

Project: Bedrock Depth

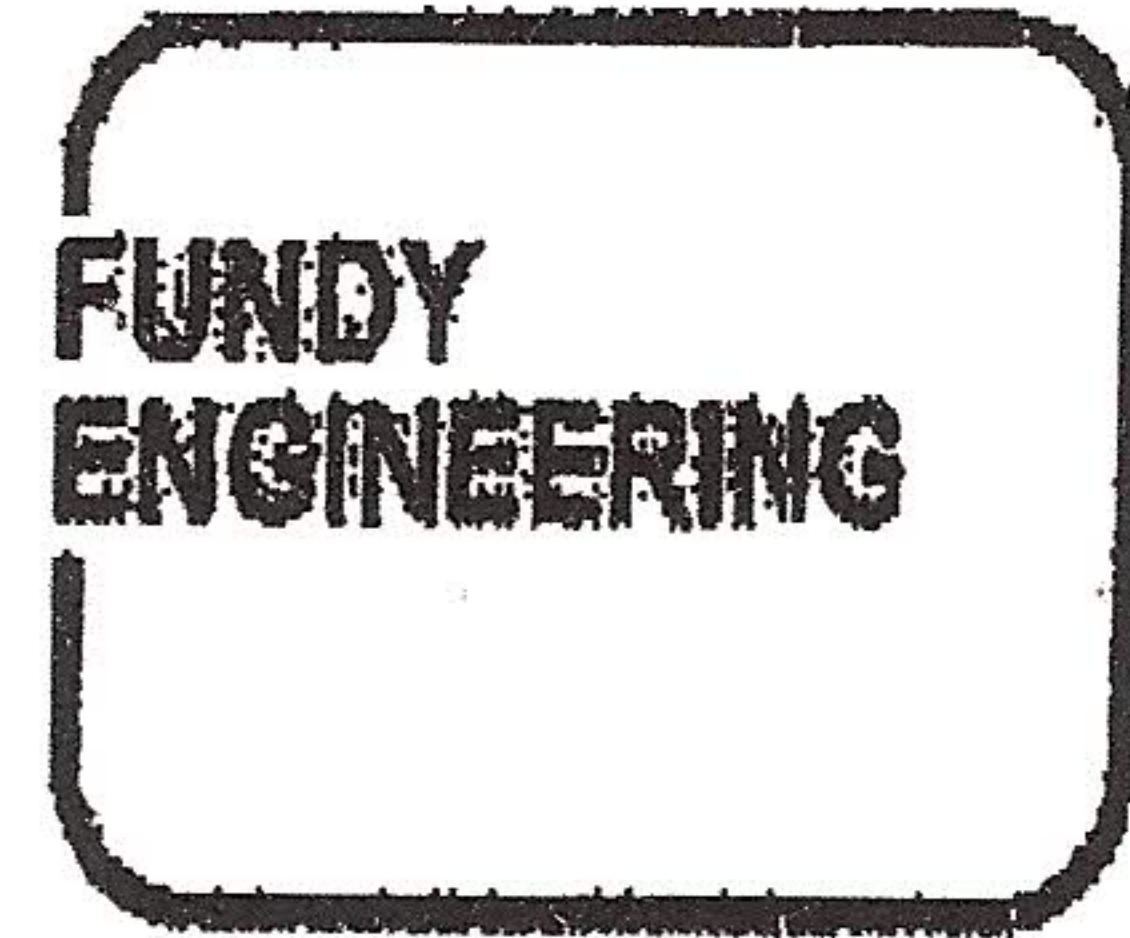

Client: Meridian Construction & Development Drill Date: June 22, 2005

Site Location: Ashburn Lake Road

Engineer: Gordon Moulard

SUBSURFACE PROFILE			SAMPLE					SPT/Moisture Content											
Depth (ft)	Elevation	Description	Symbol	Number	Type	N value/RQD	Recovery	Water Level	N-Value/%										
									10	20	30	40	50	60	70	80	90		
									Shear Vane Test										
									MPa										
									1	2	3	4							
	0.00	Ground Surface																	
		Pushed Pencone to 76 feet in depth.																	
	-76.00	Hammered Pencone to Bedrock Refusal at 129 feet.																	
	-129.00	End of Borehole																	

Drilled By: Lantech Drilling Services

Datum: Assumed

Sheet: 1 of 1

Project No: 4215

Borehole Number: 7

Project: Bedrock Depth

Client: Meridian Construction & Development Drill Date: June 23, 2005

Site Location: Ashburn Lake Road

Engineer: Gordon Mouland

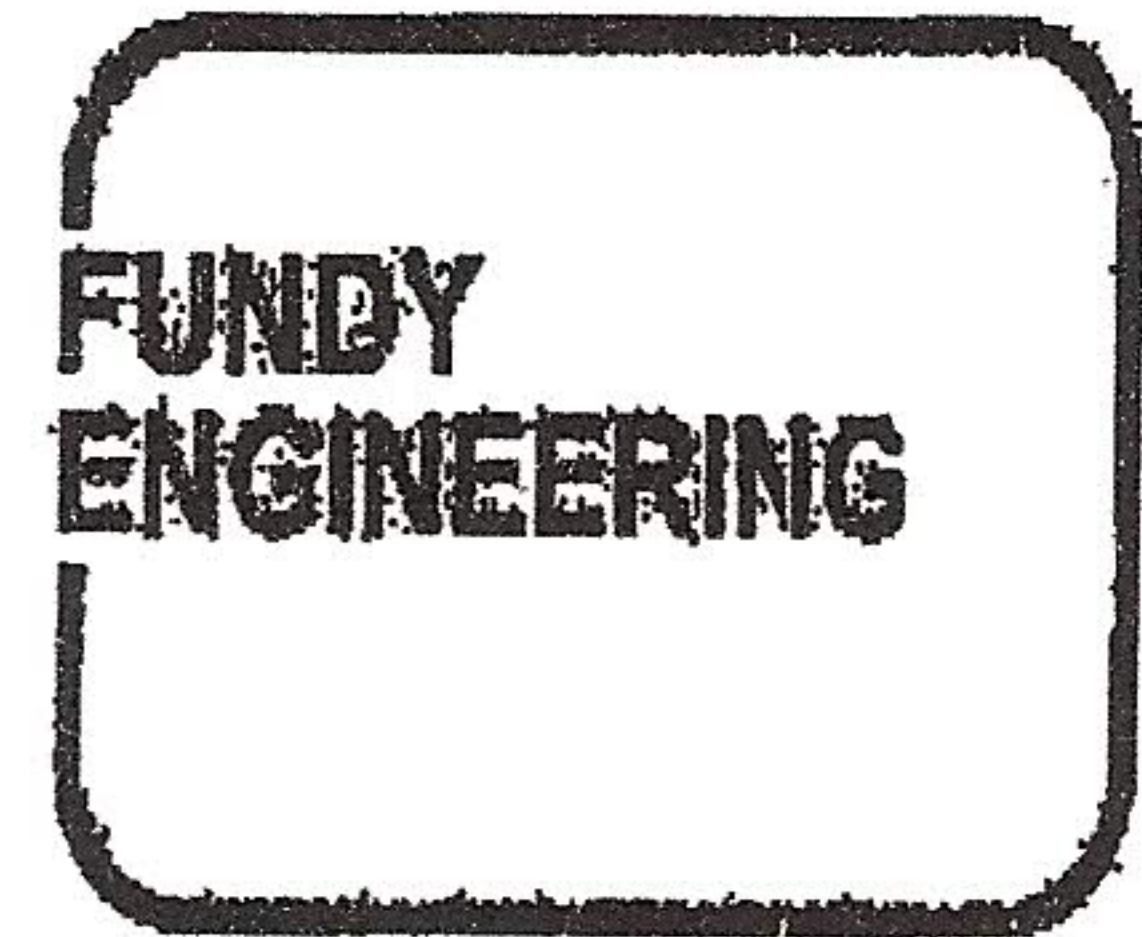

SUBSURFACE PROFILE			SAMPLE					SPT/Moisture Content						
Depth (ft)	Elevation	Description	Symbol	Number	Type	N value/RQD	Recovery	Water Level	N-Value/%					
									10	20	30	40	50	60
									Shear Vane Test					
									MPa					
									1	2	3	4		
0.00		Ground Surface												
		Loose Grey Silt With Organics												
				1	SS	0								
				2	SS	0								
				3	SS	0								
				4	SS	0								
				5	SS	3								
				6	SS	1								
-42.00		Pushed Pencone to 70 feet.		7	SS	1								
-70.00		Hammered Pencone to Bedrock Refusal.												
-99.00		End of Borehole												

Drilled By: Lantech Drilling Services

Datum: Assumed

Sheet: 1 of 1

Project No: 4215

Borehole Number: 8

Project: Bedrock Depth

Client: Meridian Construction & Development Drill Date: June 24, 2005

Site Location: Ashburn Lake Road

Engineer: Gordon Moulard

**FUNDY
ENGINEERING**

SUBSURFACE PROFILE			SAMPLE					SPT/Moisture Content						
Depth (ft)	Elevation	Description	Symbol	Number	Type	N value/RQD	Recovery	Water Level	N-Value/%					
									10	20	30	40	50	60
									Shear Vane Test					
									MPa					
									1	2	3	4		
0	0.00	Ground Surface												
1		Brown Silty Sand												
2		Bedrock Refusal												
3														
4														
5														
6														
7														
8														
9														
10	-10.00													
11	-11.00	Bedrock Refusal at 11 feet.		1	SS	100								
12		End of Borehole												
13														
14														
15														
16														
17														
18														
19														
20														
21														
22														
23														
24														
25														

Drilled By: Lantech Drilling Services

Datum: Assumed

Sheet: 1 of 1

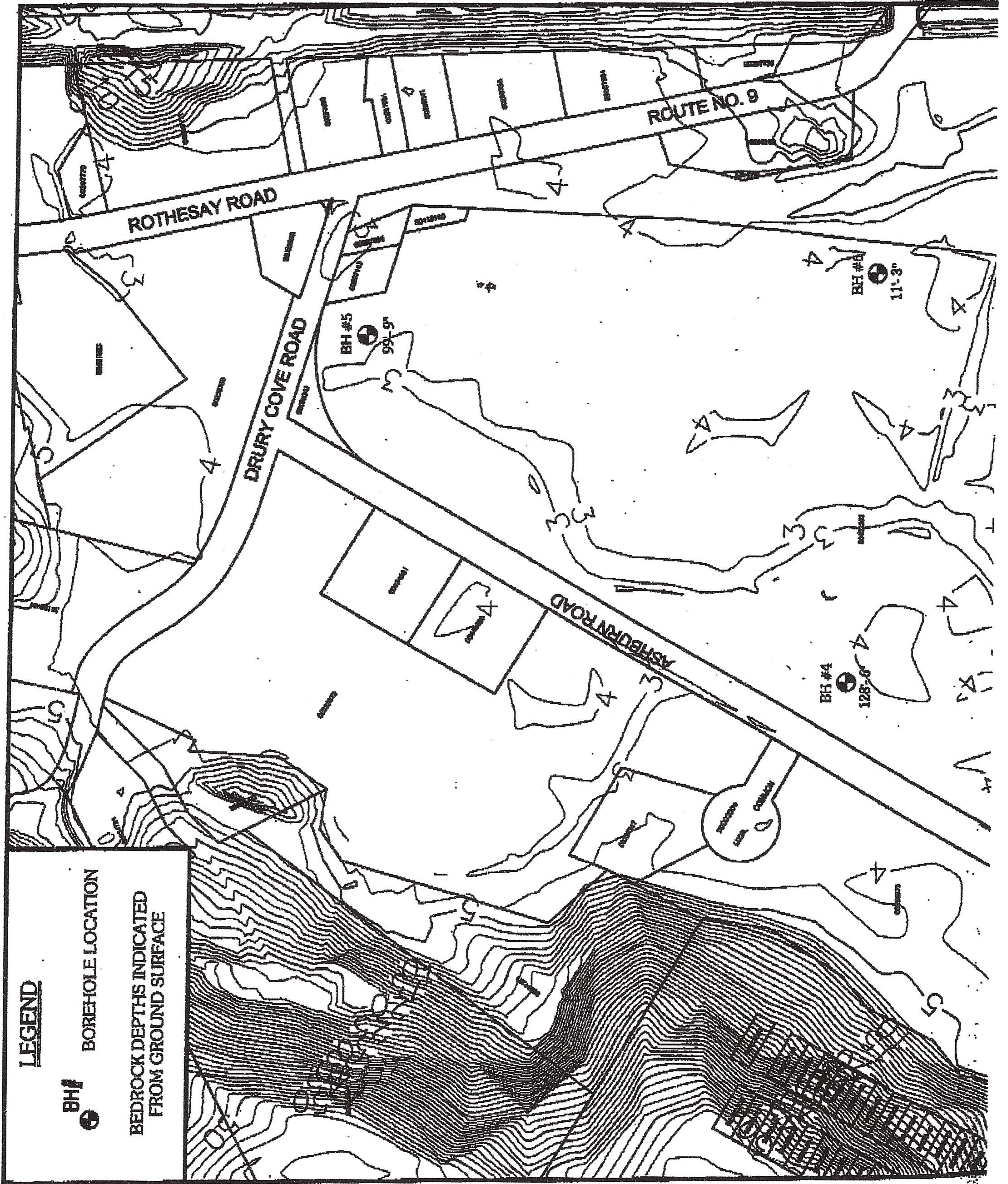

LEGEND

BH/ ● BOREHOLE LOCATION

BEDROCK DEPTHS INDICATED FROM GROUND SURFACE

